

# THE COOKTOP WAGENER STOVE

## Installation Clearances

## AS/NZ Standard 2918:2001

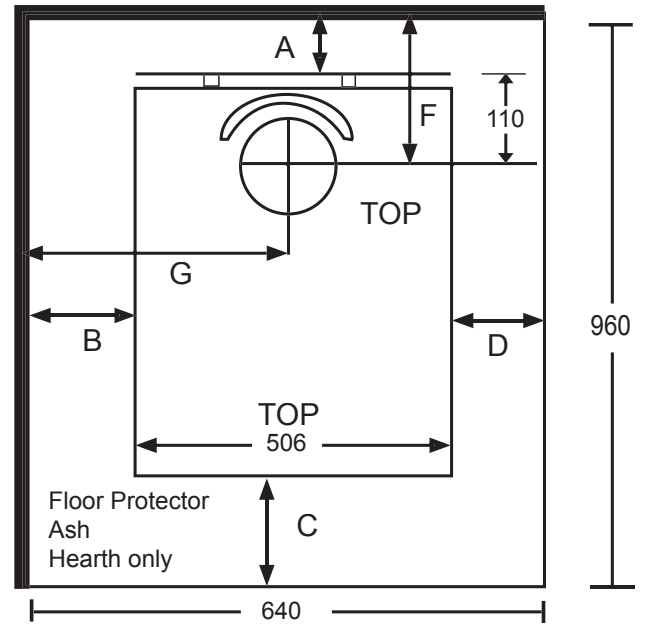
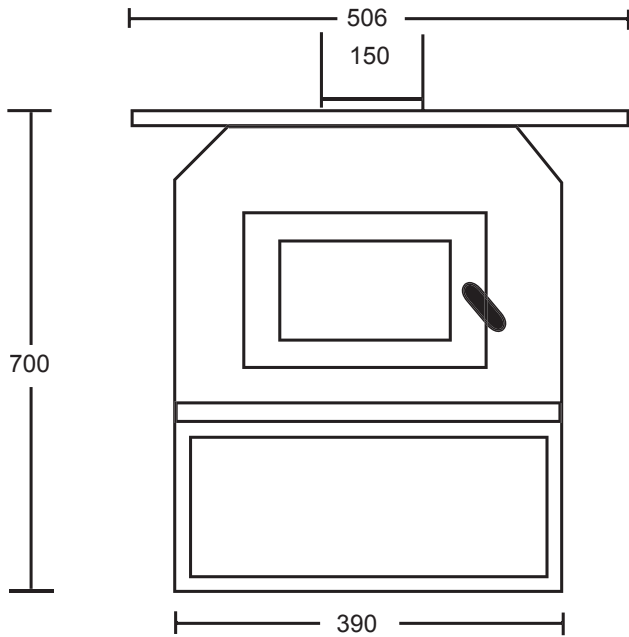

Minimum clearance to Combustible Surfaces	A	B	C	D	E	F	G	H
With double stainless steel flue shield to unprotected wall	135mm	600mm	300mm	125mm	550mm	245mm	850mm	760mm
As above 12mm Promina board spaced 25mm off wall	40mm	175mm	Floor protection must extend under the stove and forward 300mm extending 200mm either side of the door opening		160mm	150mm	428mm	370mm
As above with sheet metal any type 0.5mm or thicker spaced 25mm off the wall.	40mm	180mm			165mm	151mm	433mm	375mm
Sheet metal as above 2 sheets spaced 12mmx12mm	27mm	120mm			110mm	137mm	373mm	320mm

Other screening materials are available and clearance factors can be calculated to the AS/NZS 2918:2001. Please ask your retailer or contact Wagener Stoves if you need further advice.

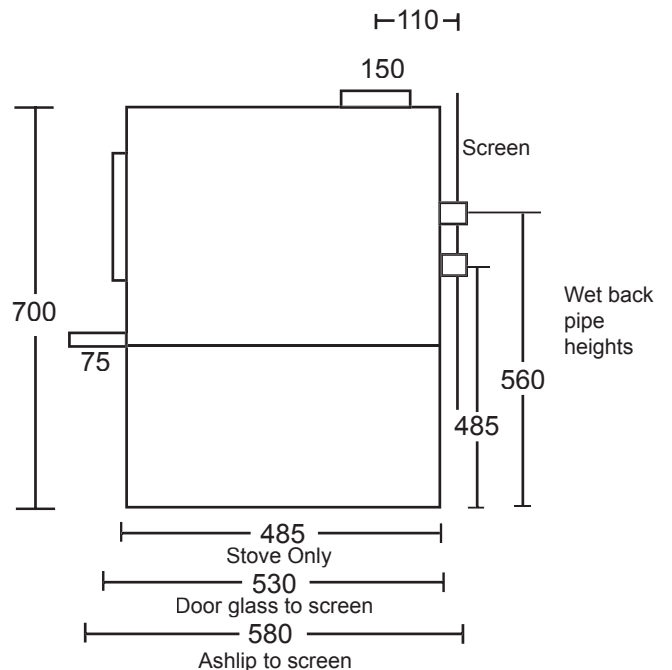
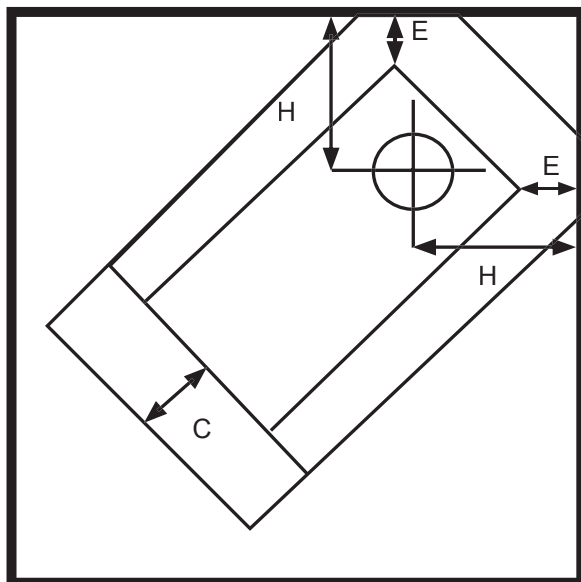

# Flue Installation

The CookTop Wagener Stove uses a 150mm diameter flue. It is imperative that the connection between the flue and the flue spigot is sealed using a recommended flue sealant. If an offset bend is required it should be as steep as possible to enable ease of cleaning.

Extra flue height may be required to compensate for lack of draw. **The performance of the CookTop Wagener stove depends more on the flue than on any other single component as it is the draw on the flue that drives the CookTop Wagener Stove.**

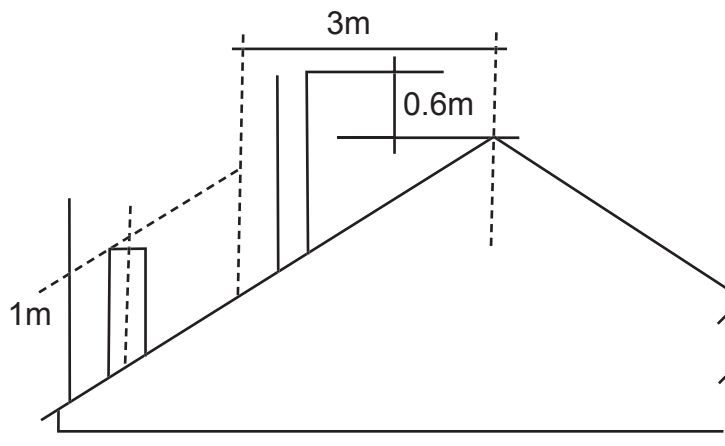

The top of the flue system should be at least 1000mm above the roof or at least 600mm higher than any obstacle or ridge within 3 metres of the flue.

A total minimum vertical flue height ABOVE the CookTop Wagener Stove of 4.2 metres is normally required for adequate draft.

Joints between sections of the flue pipes are push fitted so that the upper section enters the bottom section and must be SEALED using a flue sealant.

Each section should be secured to prevent separation using 3 stainless steel self tapping screws or pop rivets.

Only flue systems which comply with the AS/NZS 2918-2001 should be used.

Please follow flue manufacturers instructions on page 5 "150mm Free Standing Woodfire Flue Kit Installation" Instructions'.

